

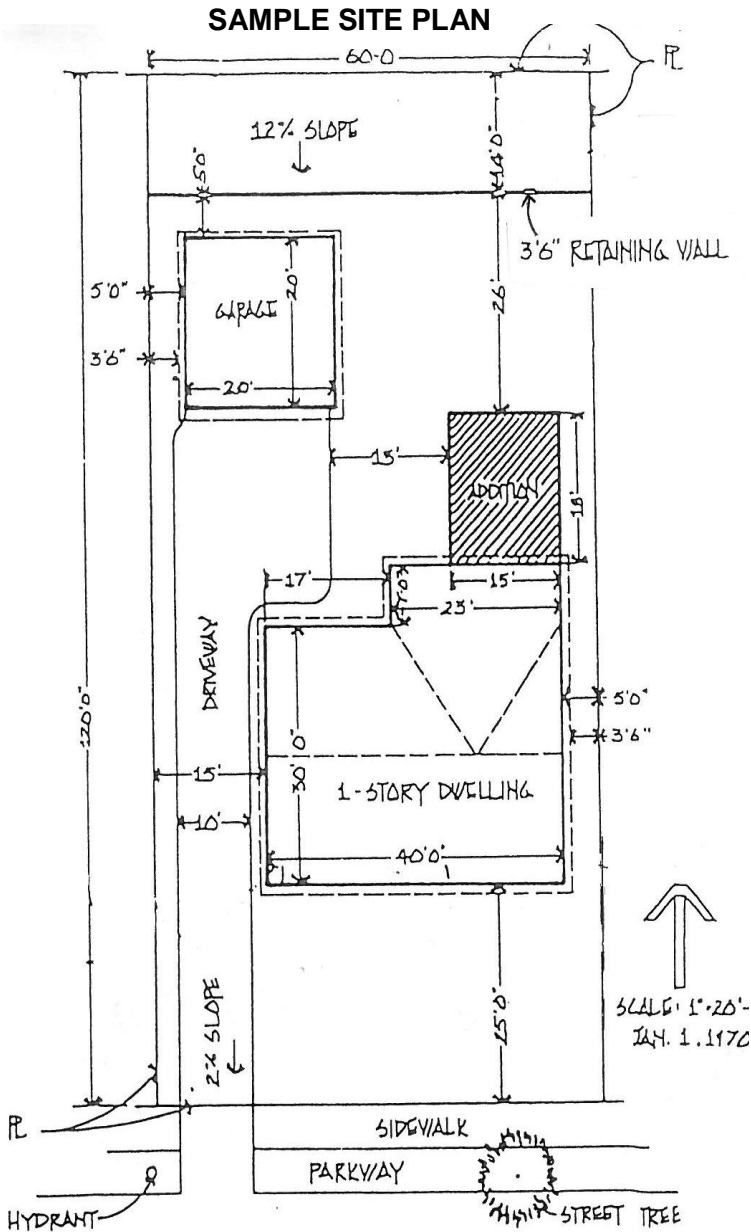

City of Monterey Park Planning Division

General Regulations*



For City Use Only

Accessory Structures

1. Shall be non-habitable buildings or structures.
2. Limited to a maximum of one structure per property.
3. Must maintain a **5 foot setback** from all property lines and existing buildings.
4. Shall be included in lot coverage calculation.

Portable Canopy

1. Limited to a maximum of 240 square feet in size.
2. Shall only be allowed adjacent to the side or at the rear of a residential unit.
3. Must not encroach into any front or side setback.
4. Must be constructed with a durable material, such as, but not limited to a canvas or vinyl material.
5. Shall not exceed a height of **15 feet** at the highest point.

HVAC Condenser Unit

1. Must be located in the rear yard or interior side yard, provided that no such equipment is located less than **5 feet** from any interior side and rear property line.
2. Conditions regarding exact location, size of unit, screening, sound proofing, color of unit, etc., may be imposed by the Planner when deemed necessary to protect surrounding properties from excessive noise or unsightly appearance.

*** Location and site plan approval are subject to approval by the Planning Division.**

The site plan shall be **drawn to scale** and all information provided accurately represents the current conditions found on the subject property as well as all proposed development.

Property Address: _____ Project Description: _____

Property Owner Name: _____ Telephone Number: _____

Property Owner/
Authorized Agent Signature: _____ Telephone Number: _____

Agent's Company Name: _____

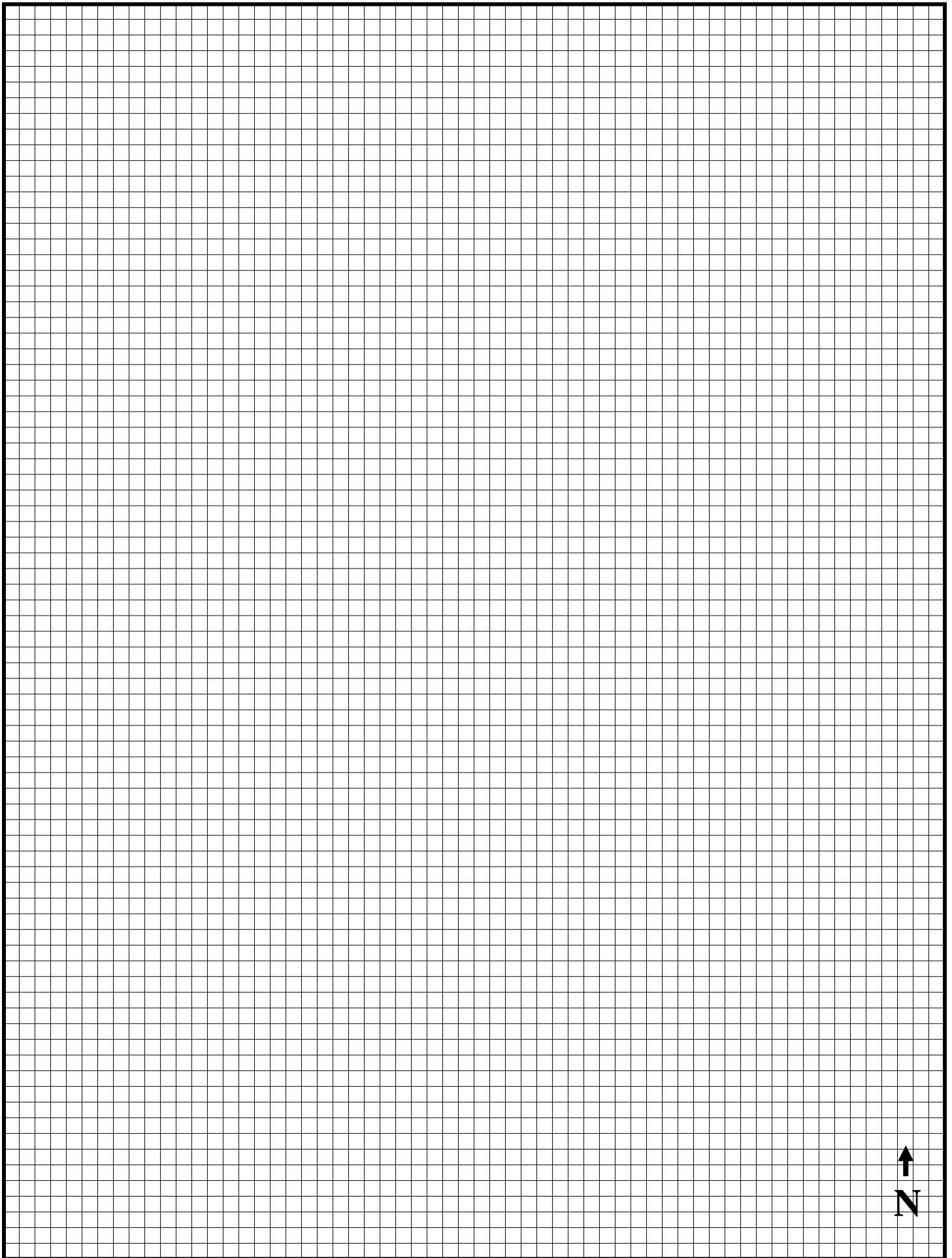

Suggested Scale: 1 square = 2 square feet