

County of Los Angeles
Department of Agricultural
Commissioner/Weights
and Measures

Weed and Brush
CLEARANCE REQUIREMENTS

IMPORTANT! Clearance requirements apply to your property even if the structure being protected is not on your property!

Okay to have ornamental plants and trees if individually planted, spaced and maintained so they do not form a means of transmitting fire from native growth to the structure. No portion of a tree may extend within 10 feet of the outlet of a chimney and it must be free of dead wood. (County Code sec. 325.2.1 EXCEPTIONS (1))

IMPORTANT! Thinning or removal of vegetation an additional 70 to 130 feet (100 to 200 feet total) from structures may be required! Please contact your Zone Inspector! (626) 575-5484 <http://acwm.lacounty.gov> Grass and other vegetation located more than 30 feet from structures and less than 18 inches in height may be maintained where necessary to stabilize soil and prevent erosion. (County Code sec. 325.2.1 EXCEPTIONS (3))

Space trees and shrubs a minimum of 15 feet or three times their diameter from other shrubs. Trees should be spaced to allow a minimum of 30 feet between canopies at maturity. For trees taller than 18 feet, prune lower branches within 6 feet of the ground. For trees and shrubs less than 18 feet, prune lower branches to 1/3 of their height. Choose landscaping plants that are fire resistant and maintain all plants regularly removing dead branches, leaves, etc. (Go to <http://fire.lacounty.gov/FromChief.asp> and scroll down the page and click on the link on the left entitled "Ready! Set! Go! Wildfire Action Plan".)

Roadway clearance, minimum of 10 feet clearance for all flammable vegetation or other combustible growth. (County Code sec. 325.10)

Firewood, manure, compost or other combustible materials must be placed or stored a minimum of 30 feet from any building or structure. (County Code sec. 325.2.1 (1))

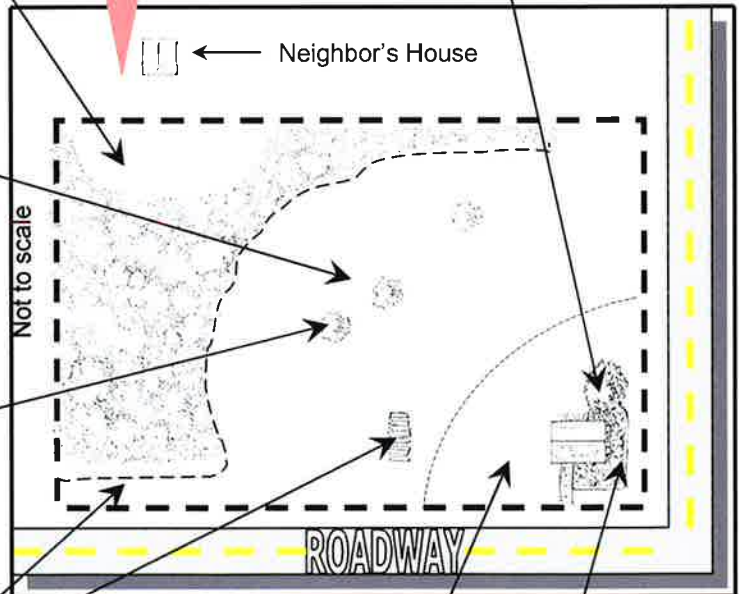

Remove/clear away all flammable vegetation or combustible growth for a distance of not less than 30 feet from any structure. This includes ornamental plants known to be flammable. (County Code sec. 325.2.1 (2))
NATIVE PLANTS CAN BE FLAMMABLE EVEN IF GREEN!

Okay to have cultivated ground cover provided they are maintained in a condition that does not form a means of transmitting fire from native growth to the structure. (County Code sec. 325.2.1 EXCEPTIONS (2))